

FM/AM Clock Radio

ICF-C218

Operating Instructions

DREAM MACHINE

Dream Machine is a trademark of Sony Corporation.

© 2006 Sony Corporation Printed in China

<http://www.sony.net/>

SONY®

Portable Audio

LIMITED WARRANTY (U.S. Only)

Sony Electronics Inc. ("Sony") warrants this product against defects in material or workmanship for the time periods and as set forth below. Pursuant to this Limited Warranty, Sony will, at its option, (i) repair the product using new or refurbished parts or (ii) replace the product with a new or refurbished product. For purposes of this Limited Warranty, "refurbished" means a product or part that has been returned to its original specifications. **In the event of a defect, these are your exclusive remedies.**

Term: For a period of one (1) year from the original date of purchase of the product, Sony will, at its option, repair or replace with new or refurbished product or parts, any product or parts determined to be defective.

This Limited Warranty covers only the hardware components packaged with the Product. It does not cover technical assistance for hardware or software usage and it does not cover any software products whether or not contained in the Product; any such software is provided "AS IS" unless expressly provided for in any enclosed software Limited Warranty. Please refer to the End User License Agreements included with the Product for your rights and obligations with respect to the software.

Instructions: To obtain warranty service, you must deliver the product, freight prepaid, in either its original packaging or packaging affording an equal degree of protection to the Sony authorized service facility specified. **It is your responsibility to backup any data, software or other materials you may have stored or preserved on your unit. It is likely that such data, software, or other materials will be lost or reformatted during service and Sony will not be responsible for any such damage or loss.** A dated purchase receipt is required. For specific instructions on how to obtain warranty service for your product,

The Address of the Laredo Fulfillment Center is:

Laredo Fulfillment Center
10227 Crossroads Loop Suite B
Laredo, TX 78045

Visit Sony's Web Site:
www.sony.com/service

Or call the **Sony Customer Information Service Center**
1-800-222-SONY (7669)

For an accessory or part not available from your authorized dealer, call:

1-800-488-SONY (7669)

Repair / Replacement Warranty: This Limited Warranty shall apply to any repair, replacement part or replacement product for the remainder of the original Limited Warranty period or for ninety (90) days, whichever is longer. Any parts or product replaced under this Limited Warranty will become the property of Sony.

This Limited Warranty only covers product issues caused by defects in material or workmanship during ordinary consumer use; it does not cover product issues caused by any other reason, including but not limited to product issues due to commercial use, acts of God, misuse, limitations of technology, or modification of or to any part of the Sony product. This Limited Warranty does not cover Sony products sold AS IS or WITH ALL FAULTS or consumables (such as fuses or batteries). This Limited Warranty is invalid if the factory-applied serial number has been altered or removed from the product. This Limited Warranty is valid only in the United States.

LIMITATION ON DAMAGES: SONY SHALL NOT BE LIABLE FOR ANY INCIDENTAL OR CONSEQUENTIAL DAMAGES FOR BREACH OF ANY EXPRESS OR IMPLIED WARRANTY ON THIS PRODUCT.

DURATION OF IMPLIED WARRANTIES: EXCEPT TO THE EXTENT PROHIBITED BY APPLICABLE LAW, ANY IMPLIED WARRANTY OF MERCHANTABILITY OR FITNESS FOR A PARTICULAR PURPOSE ON THIS PRODUCT IS LIMITED IN DURATION TO THE DURATION OF THIS WARRANTY.

Some states do not allow the exclusion or limitation of incidental or consequential damages, or allow limitations on how long an implied warranty lasts, so the above limitations or exclusions may not apply to you. This Limited Warranty gives you specific legal rights and you may have other rights which vary from state to state.

D455714605

For customers who purchased this product in the USA

Please register this product on line at <http://www.sony.com/productregistration>. Proper registration will enable us to send you periodic mailings about new products, services, and other important announcements. Registering your product will also allow us to contact you in the unlikely event that the product needs adjustment or modification. Thank you.

WARNING

To reduce the risk of fire or electric shock, do not expose this apparatus to rain or moisture.

You are cautioned that any changes or modifications not expressly approved in this manual could void your authority to operate this equipment.

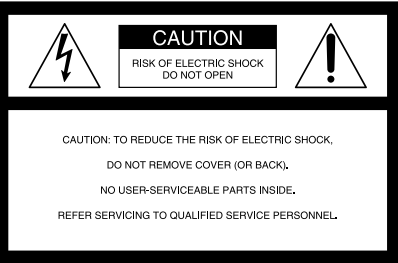

This symbol is intended to alert the user to the presence of uninsulated "dangerous voltage" within the product's enclosure that may be of sufficient magnitude to constitute a risk of electric shock to persons.



This symbol is intended to alert the user to the presence of important operating and maintenance (servicing) instructions in the literature accompanying the appliance.

* The graphical symbols are at the bottom of the unit.

INFORMATION

This equipment has been tested and found to comply with the limits for a Class B digital device, pursuant to Part 15 of the FCC Rules. These limits are designed to provide reasonable protection against harmful interference in a residential installation. This equipment generates, uses and can radiate radio frequency energy and, if not installed and used in accordance with the instructions, may cause harmful interference to radio communications. However, there is no guarantee that interference will not occur in a particular installation. If this equipment does cause harmful interference to radio or television reception, which can be determined by turning the equipment off and on, the user is encouraged to try to correct the interference by one or more of the following measures:

- Reorient or relocate the receiving antenna.
- Increase the separation between the equipment and receiver.
- Connect the equipment into an outlet on a circuit different from that to which the receiver is connected.
- Consult the dealer or an experienced radio/TV technician for help.

WARNING

Battery may explode if mistreated. Do not recharge, disassemble or dispose of in fire.

For the state of california, USA only

Perchlorate Material –special handling may apply, See www.dtsc.ca.gov/hazardouswaste/perchlorate

Perchlorate Material: Lithium battery contains perchlorate

Features

- Single alarm FM/AM Clock radio.
- Various types of alarms — radio and buzzer.
- Automatic time set — When you plug the clock in for the first time, the current time will be shown in the display.
- Automatic Daylight Saving Time/Summer time adjustment.
- Date button to display month, day and year.
- Battery backup to keep the clock during a power interruption with a CR2032 battery installed.
- Extendable snooze — snooze time can be extended from 10 to 60 minutes in maximum every time you use.

Troubleshooting

Should any problem occur with the unit, make the following simple checks to determine whether or not servicing is required. If the problem persists, consult your nearest Sony dealer.

The clock flashes "AM 12:00" due to a power interruption.

- The battery is low. Replace the battery. Remove the old battery and install a new one.

The radio or buzzer alarm does not sound at the preset alarm time.

- Has the desired radio or buzzer alarm been activated? (i.e., Does the ALARM indicator light up?)

The radio alarm is activated but no sound comes on at the preset alarm time.

- Has **VOLUME** been adjusted?

Precautions

- Operate the unit on the power sources specified in "Specifications" .
- To disconnect the power cord (mains lead), pull it out by the plug, not the cord.
- Do not leave the unit in a location near a heat source, such as a radiator or airduct, or in a place subject to direct sunlight, excessive dust, mechanical vibration, or shock.
- Allow adequate air circulation to prevent internal heat build-up. Do not place the unit on a surface (a rug, blanket, etc.) or near materials (a curtain) that might block the ventilation holes.
- Should any solid object or liquid fall into the unit, unplug the unit and have it checked by a qualified personnel before operating it any further.
- To clean the casing, use a soft cloth dampened with a mild detergent solution.

If you have any questions or problems concerning your unit, please consult your nearest Sony dealer.

Specifications

Time display

12-hour System

Frequency range

Band	Frequency
FM	87.5 – 108 MHz
AM	530 – 1 710 kHz

Speaker

Approx. 6.6 cm (2 ⁵/₁₆ inches) dia., 8 Ω

Power output

150 mW (at 10% harmonic distortion)

Power requirements

120 V AC, 60 Hz
For power backup: 3 V DC, one CR2032 battery

Dimensions

Approx. 155 × 64.5 × 150 mm (w/h/d)
(6 ⁷/₈ × 2 ⁵/₁₆ × 6 inches) incl. projecting parts and controls

Mass

Approx. 495.2 g (1 lb 1.5 oz) incl. CR2032 battery

Design and specifications are subject to change without notice.

IMPORTANT SAFEGUARDS

For your protection, please read these safety instructions completely before operating the appliance, and keep this manual for future reference.

Carefully observe all warnings, precautions and instructions on the appliance and in the operating instructions, and adhere to them.

INSTALLATION

Water and Moisture

Do not use powerline operated appliances near water - for example, near a bathtub, washbowl, kitchen sink, or laundry tub, in a wet basement, or near a swimming pool, etc.

Heat

Do not place the appliance near or over a radiator or heat register, or where it is exposed to direct sunlight.

Ventilation

The slots and openings in the cabinet are provided for necessary ventilation. To ensure reliable operation of the appliance, and to protect it from overheating, these slots and openings must never be blocked or covered.

-Never cover the slots and openings with a cloth or other materials.

-Never block the slots and openings by placing the appliance on a bed, sofa, rug or other similar surface.

-Never place the appliance in a confined space, such as a bookcase, or built-in cabinet, unless proper ventilation is provided.

Accessories

Do not place the appliance on an unstable cart, stand, tripod, bracket, or table. The appliance may fall, causing serious injury to a child or an adult, and serious damage to the appliance. Use only a cart, stand, tripod, bracket, or table recommended by Sony.

-An appliance and cart combination should be moved with care. Quick stops, excessive force, and uneven surfaces may cause the appliance and cart combination to overturn.

Wall or Ceiling Mounting

If your appliance can be mounted to a wall or ceiling, mount it only as recommended by Sony.

USE

Power Source

This appliance should be operated only from the type of power source indicated on the marking label. If you are not sure of the type of electrical power supplied to your home, consult your dealer or local power company. For those appliances designed to operate from battery power, or other sources, refer to the operating instructions.

Grounding or Polarization

This appliance is equipped with a polarized AC power cord plug (a plug having one blade wider than the other), or with a three-wire grounding type plug (a plug having a third pin for grounding). Follow the instructions below:

-For the appliance with a polarized AC power cord plug:

This plug will fit into the power outlet only one way. This is a safety feature. If you are unable to insert the plug fully into the outlet, try reversing the plug. If the plug should still fail to fit, contact your electrician to have a suitable outlet installed. Do not defeat the safety purpose of the polarized plug by forcing it in.

-For the appliance with a three-wire grounding type AC plug:

This plug will only fit into a grounding-type power outlet. This is a safety feature. If you are unable to insert the plug into the outlet, contact your electrician to have a suitable outlet installed. Do not defeat the safety purpose of the grounding plug.

Overloading

Do not overload wall outlets, extension cords or convenience receptacles beyond their capacity, since this can result in fire or electric shock.

When not in use

Unplug the power cord of the appliance from the outlet when left unused for a long period of time. To disconnect the cord, pull it out by grasping the plug. Never pull the plug out by the cord.

Power-Cord Protection

Route the power cord so that it is not likely to be walked on or pinched by items placed upon or against them, paying particular attention to the plugs, receptacles, and the point where the cord exits from the appliance.

Lightning

For added protection for this appliance during a lightning storm, or when it is left unattended and unused for long periods of time, unplug it from the wall outlet and disconnect the antenna or cable system. This will prevent damage to the appliance due to lightning and powerline surges.

Object and Liquid Entry

Never push objects of any kind into the appliance through openings as they may touch dangerous voltage points or short out parts that could result in a fire or electric shock. Never spill liquid of any kind on the appliance.

Cleaning

Unplug the appliance from the wall outlet before cleaning or polishing it. Do not use liquid cleaners or aerosol cleaners. Use a cloth lightly dampened with water for cleaning the exterior of the appliance. Clean the appliance only as recommended by Sony.

Attachments

Do not use attachments not recommended by Sony, as they may cause hazards.

ANTENNAS

Outdoor Antenna Grounding

If an outdoor antenna or cable system is installed, follow the precautions below.

An outdoor antenna system should not be located in the vicinity of overhead power lines or other electric light or power circuits, or where it can come in contact with such power lines or circuits. WHEN INSTALLING AN OUTDOOR ANTENNA SYSTEM, EXTREME CARE SHOULD BE TAKEN TO KEEP FROM CONTACTING SUCH POWER LINES OR CIRCUITS AS CONTACT WITH THEM IS ALMOST INVARIABLY FATAL.

Be sure the antenna system is grounded so as to provide some protection against voltage surges and built-up static charges. Section 810 of the National Electrical Code provides information with respect to proper grounding of the mast and supporting structure, grounding of the lead-in wire to an antenna discharge unit, size of grounding conductors, location of antenna-discharge unit, connection to grounding electrodes, and requirements for the grounding electrode.

Antenna Grounding According to the National Electrical Code

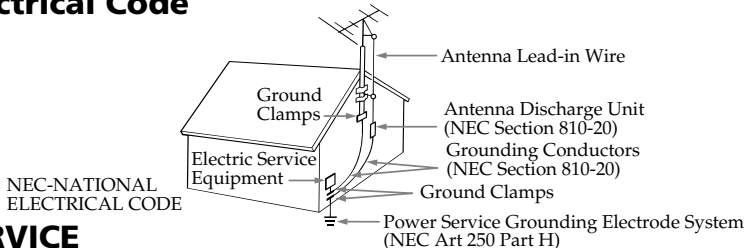

SERVICE

Damage Requiring Service

Unplug the appliance from the wall outlet and refer servicing to qualified service personnel under the following conditions:

- When the power cord or plug is damaged or frayed.
- If liquid has been spilled or objects have fallen into the appliance.
- If the appliance has been exposed to rain or water.
- The appliance does not appear to operate normally or exhibits a marked change in performance.
- This indicates a need for service.
- If the appliance does not operate normally when following the operating instructions, adjust only those controls that are specified in the operating instructions. Improper adjustment of other controls may result in damage and will often require extensive work by a qualified technician to restore the appliance to normal operation.
- If the appliance has been subject to excessive shock by being dropped, or the cabinet has been damaged.

Servicing

Do not attempt to service the appliance yourself as opening or removing covers may expose you to dangerous voltage or other hazards.

Refer all servicing to qualified service personnel.

Replacement parts

When replacement parts are required, be sure the service technician has used replacement parts specified by Sony that have the same characteristics as the original parts.

Unauthorized substitutions may result in fire, electric shock, or other hazards.

Safety Check

Upon completion of any service or repairs to the appliance, ask the service technician to perform routine safety checks (as specified by Sony) to determine that the appliance is in safe operating condition.

This unit includes a preinstalled Sony Lithium battery (CR2032) as back-up power source for the clock, which is preset to EST/EDT (Eastern Standard Time/Daylight Time) at the factory. And this battery is considered part of the product.

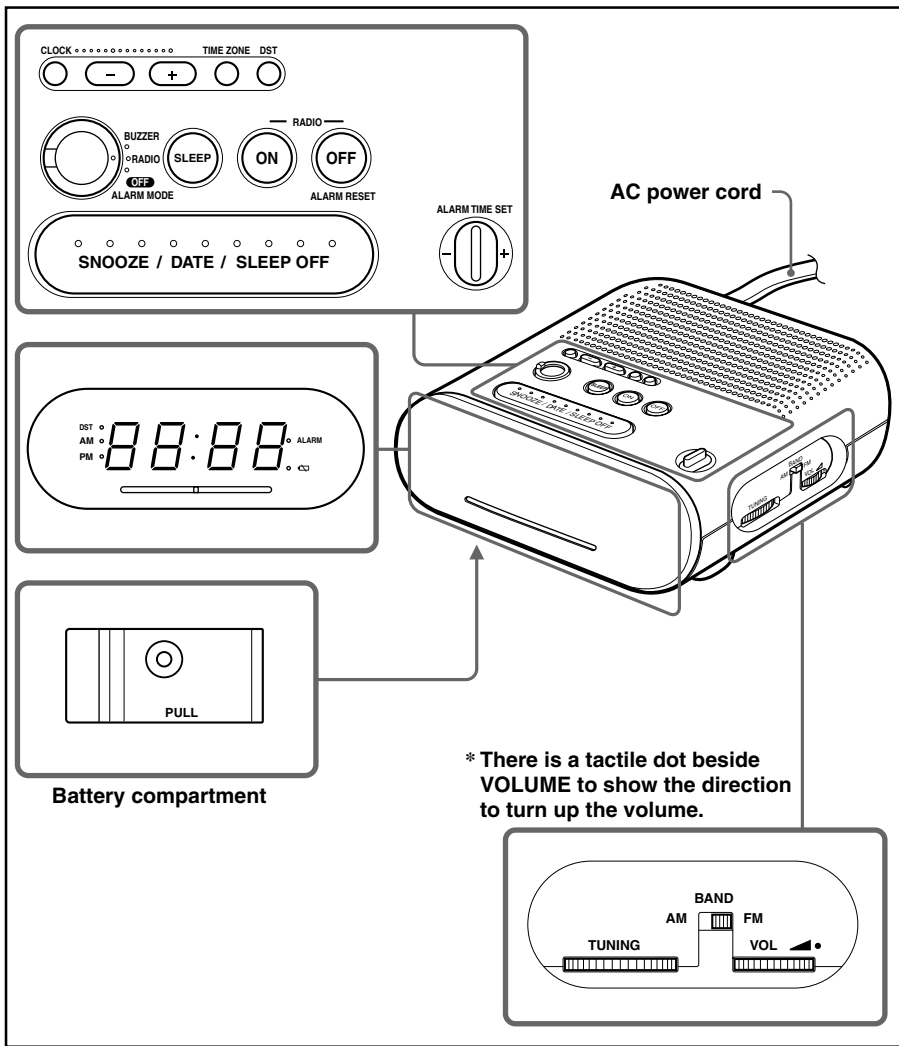

* There is a tactile dot beside **VOLUME** to show the direction to turn up the volume.

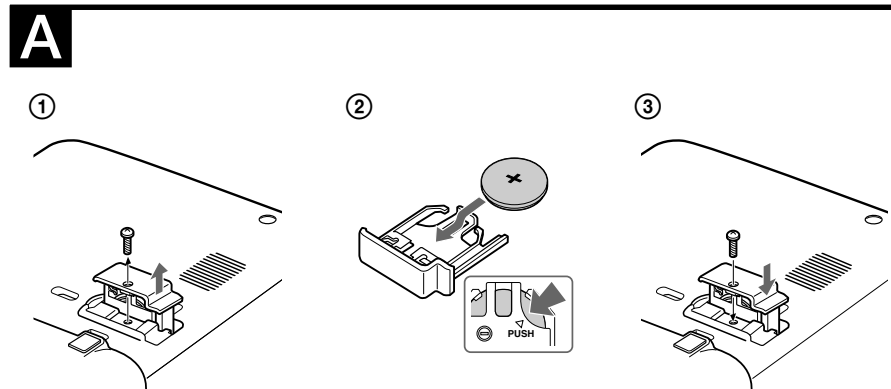

About the backup battery

To keep good time, as backup power source, this unit has one CR2032 battery inside of the unit in addition to the house current. The battery keeps the clock in the event of a power interruption.

Knowing when to replace the battery

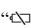
When the battery becomes weak, “” indicator appears in the display. In the event of a power interruption when the battery is weak, current time and alarm functions will be initialized.

Replace the battery with a Sony CR2032 lithium battery. Use of another battery may present a risk of fire or explosion.

Installing and replacing the backup battery

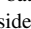
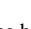
- Keep the AC plug connected to the AC outlet, remove the screw that secures the battery compartment at the bottom of the unit using a screwdriver, and remove the battery compartment. (See Fig. **A-①**)
- Insert a new battery in the battery compartment with the  side facing up. To remove the battery from the battery compartment, push it out from the side marked PUSH. (See Fig. **A-②**)
- Insert the battery compartment back into the unit and secure it with the screw. (See Fig. **A-③**)
- When you are replacing the battery, press **RADIO ON** to turn “” indicator off in the display.

Note

If you replace the battery, do not disconnect AC plug from AC outlet. Otherwise, current time and alarm will be initialized.

NOTES ON LITHIUM BATTERY

- Dispose of used battery promptly. Keep the lithium battery out of the reach of children. Should the battery be swallowed, immediately consult a doctor.
- Wipe the battery with a dry cloth to assure a good contact.
- Be sure to observe the correct polarity when installing the battery.
- Do not hold the battery with metallic tweezers, otherwise a short-circuit may occur.
- Do not expose the battery to excessive heat such as direct sunlight, fire or the like.

Battery Warning

When the unit will be left unplugged for a long time, remove the battery to avoid undue battery discharge and damage to the unit from battery leakage.

Setting the clock for the first time

This unit is preset to the current date and time at the factory, and is powered by the back up battery. All you need to do the first time is just plug it in and select your time zone.

- Plug in the unit. “month and date” (about 1 second) → “year” (about 1 second) → “the current EST/EDT (Eastern Standard/Daylight Time)” appears in the display.
- Press **TIME ZONE**. Area number “2” appears in the display. If you live in the Eastern Time zone, you do not need to adjust the area setting.

Area number	Time zone
1	Atlantic Standard/Daylight Time
2	Eastern Standard/Daylight Time (default)
3	Central Standard/Daylight Time
4	Mountain Standard/Daylight Time
5	Pacific Standard/Daylight Time
6	Yukon Standard/Daylight Time
7	Hawaiian Standard/Daylight Time

- Press **TIME ZONE** repeatedly until the desired number appears. The display returns to the clock about 4 seconds after the operation is complete.

Note

During the shipment and your first use, a clock error may occur. In this case, refer to “Setting the clock and date” to set the correct time.

When daylight saving time (summer time) begins

The following models employ the Automatic Daylight Saving Time/Summer Time adjustment. The DST indicator in the display appears in the display at the beginning of the daylight saving time (summer time), and disappears at the end of it.

- Daylight saving time begins at: 2:00 AM on the second Sunday of March.
- Standard time begins at: 2:00 AM on the first Sunday of November.

To cancel the Automatic DST/Summer Time adjustment and to set DST display manually

The Automatic DST/Summer Time adjustment can be cancelled.

Press and hold **DST** for more than 3 seconds while the clock is displayed.

A beep sounds, and “Aut → OFF” appears in the display to show that the Automatic DST/Summer Time adjustment is cancelled. The display returns to the clock.

Notes

- The change timing of Automatic DST/Summer Time adjustment employed by the unit (see above) is subjected to variation by circumstances and the law in each country/region. In such a case, cancel the Automatic DST/Summer Time adjustment and set DST display manually as necessary. The customer who lives in the country/region that has not introduced the daylight saving time (summer time) must cancel Automatic DST/Summer Time adjustment before using the set.
- To activate the Automatic DST/Summer Time adjustment again, press and hold **DST** for more than 3 seconds. A beep sounds, and “Aut → On” appears in the display to show that the Automatic DST/Summer Time adjustment is activated. The display returns to the clock.
- To change the display to the daylight saving time (summer time) manually, see “To change the display to the daylight saving time (summer time) indication.”

Setting the clock and date

To change the setting manually, follow the procedure from step 1.

- Press **CLOCK** for more than 2 seconds. You will hear a beep and the year will start to flash in the display.
- Press **+** or **-** until the correct year appears in the display.
- Press **CLOCK**.
- Repeat steps 2 and 3 to set the month, day and time. After setting the time, two short beeps sound and the clock starts from 0 seconds.

- Pressing and holding **+** or **-** changes the year, month or day rapidly. When setting the current time, time changes rapidly by 1 minute-increments up to 10 minutes, and then by 10 minute-increments.
- While setting the clock, you must perform each step within 65 seconds, or the clock setting mode will be cancelled.

To display the year and date

Press **SNOOZE/DATE/SLEEP OFF** once for the date, and within about 3 seconds press it again for the year.

The display shows the date or year for about 3 seconds and then changes back to the current time. If you connect the AC plug to AC outlet while this unit is powered from the backup power source, the current date and time appears in the following order. (It is same as when the unit is powered on after the power failure.) “month and date” (about 1 second) → “year” (about 1 second) → “current time”

To change the display to the daylight saving time (summer time) indication

Change the daylight saving time (summer time) adjustment setting according to the following procedures if you have cancelled the Automatic DST/Summer Time adjustment.

Press **DST**.

DST indicator appears in the display and the time indication changes to the daylight saving time (summer time).

To deactivate the daylight saving time (summer time) adjustment, press **DST** again.

Playing the radio

- Press **RADIO ON** to turn on the radio.
- Adjust volume using **VOLUME**.
- Select **BAND**.
- Tune in to a station using **TUNING**.

To turn off the radio

Press **RADIO OFF/ALARM RESET**.

Improving the reception

FM:

The AC power cord functions as an FM antenna. Extend the AC power cord fully to increase reception sensitivity.

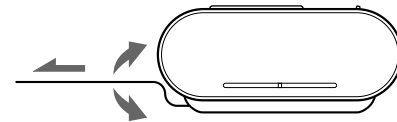

AM:

Rotate the unit horizontally for optimum reception. A ferrite bar AM antenna is built-in to the unit.

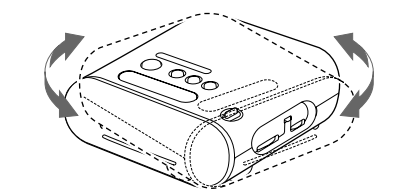

Do not operate the unit over a steel desk or metal surface, as this may lead to interference of reception.

Setting the alarm

The alarm function can be selected from two alarm sounds, RADIO or BUZZER.

Notes

- Before setting the alarm, make sure to set the clock (see “Setting the clock and date”).
- The factory setting alarm time is “PM 12:00”.
- To set the radio alarm, first tune in to a station and adjust the volume (see “Playing the radio”).

To set the alarm time

- Set **ALARM MODE** to the desired alarm sound (**RADIO** or **BUZZER**). The alarm time appears for a few seconds, and then the ALARM indicator lights up in the display. (It does not appear when the switch is set to **OFF**.)
- Slide **ALARM TIME SET + or -** to set the desired time. Each slide of **ALARM TIME SET + or -** changes the indication by 1 minute. If you keep sliding **ALARM TIME SET + or -**, the alarm time goes forward (or backward) by 1 minute up to 10 minutes, and then by 10 minutes increments. While setting the alarm time, the ALARM indicator flashes in the display.



When the alarm time setting operation is complete, the display returns to the clock after a few seconds and the ALARM indicator changes from flashing to fully lit.

- While **ALARM MODE** is set to **RADIO** or **BUZZER**, the alarm time setting can be changed by **ALARM TIME SET**. One slide of **ALARM TIME SET** displays the alarm time for about 4 seconds. By adjusting **ALARM TIME SET** while the alarm time appears in the display, the alarm time will be changed.
- The ALARM indicator flashes in the display while:
 - The alarm time appears in the display.
 - The alarm sounds.
 - Snooze function is turned on.
- The alarm time setting cannot be changed if **ALARM MODE** is set to **OFF**. If **ALARM TIME SET** is adjusted, “OFF” appears in the display for about 0.5 seconds.
- CLOCK, DST, and TIME ZONE** are unavailable while the alarm sounds or snooze function is turned on.
- The alarm function works as usual at the beginning and end day of the daylight saving time (summer time). While the Automatic DST/Summer Time adjustment is set, as a result, if the alarm is set at a time skipped when the daylight saving time (summer time) begins, the alarm is skipped, or if the alarm is set at a time overlapped when the daylight saving time (summer time) ends, the alarm sounds twice.

To doze for a few more minutes

Press **SNOOZE/DATE/SLEEP OFF**.

The sound turns off but will automatically come on again after about 10 minutes. Each time you press **SNOOZE/DATE/SLEEP OFF**, the snooze time changes as follows:

10 → 20 → 30 → 40 → 50 → 60

The maximum length of the snooze time is 60 minutes.

The display shows the snooze time for about 4 seconds and returns to show the current time. When you press **SNOOZE/DATE/SLEEP OFF** after the current time appears, the snooze time starts from 10 minutes again.

To stop the Alarm

Press **RADIO OFF/ALARM RESET** to turn off the alarm.

The alarm will come on again at the same time the next day.

If **RADIO OFF/ALARM RESET** is not pressed, the alarm sounds continuously for about 60 minutes, and then it will be stop automatically.

To deactivate the Alarm

Turn **ALARM MODE** to **OFF**.

ALARM indicator disappears from the display.

Note on alarm in the event of a power interruption

If the alarm set time comes in the event of a power interruption or a power interruption occurs while the alarm is sounding, the display will turn off and the alarm will not sound, and the alarm status will be as follows. If power returns within 60 minutes from the alarm set time, the alarm will sound. If the power interruption occurred while the Snooze function was operating, the snooze function will continue. If the snooze time had passed when the power interruption occurred, the alarm will sound after power returns.

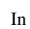
In this status, if the  indicator does not light up, **RADIO OFF/ALARM RESET, SNOOZE** buttons and **ALARM MODE** functions are available. **SNOOZE** time will be fixed only 10 minutes if the **SNOOZE** button has been pressed.

Setting the sleep timer

You can fall asleep to the radio using the built-in sleep timer that turns off the radio automatically after a preset duration.

Press **SLEEP**.

The radio turns on. You can set the sleep timer to durations of 90, 60, 30, or 15 minutes. Each press changes the display as follows:

OFF → 90 → 60
 ↙ 15 ← 30 ↘

Two short beeps sound when the display returns to “90”.

The radio will play for the duration you set, then shut off.

To turn off the radio before the preset time

Press **RADIO OFF/ALARM RESET** or **SNOOZE/DATE/SLEEP OFF**.

To use both sleep timer and alarm

You can fall asleep to the radio and also be awakened by the radio or buzzer alarm at the preset time.

- Set the alarm. (See “Setting the alarm”.)
- Set the sleep timer. (See “Setting the sleep timer”.)